



# APE Single Acting Diesel Impact Hammer

THE WORLD'S LARGEST PILEDRIVERS

Model D25-21

## SPECIFICATIONS

Stroke at Maximum Rated Energy	135 in (343 cm)
Maximum Rated Energy (Setting 4)	62,010 ft-lbs (84.07 kNm)
(Setting 3)	51,468 ft-lbs (69.78 kNm)
(Setting 2)	40,927 ft-lbs (55.49 kNm)
Minimum Rated Energy (Setting 1)	30,385 ft-lbs (41.19 kNm)
(VARIABLE THROTTLE ALLOWS FOR INFINITE FUEL SETTING)	
Maximum Obtainable Stroke	150 in (381 cm)
Maximum Obtainable Energy	68,900 ft-lbs (93.41 kNm)
Speed (Blows Per Minute)	34-53

## WEIGHTS (APPROXIMATE)

Piston	5,512 lbs (2,500 kg)
Anvil	749 lbs (340 kg)
Anvil Cross Sectional Area	124.42 in <sup>2</sup> (802.71 cm <sup>2</sup> )
Hammer Weight (Includes Trip Device)	11,800 lbs (5,352 kg)
Typical Operating (Weight With DB26 & H-Beam insert)	14,452 lbs (6,555 kg)

## CAPACITIES

Fuel Tank (Runs on Diesel or Bio-Diesel)	8.3 Gal (31.4 Liters)
Oil Tank	2.3 Gal (8.7 Liters)

## CONSUMPTION

Diesel or Bio-Diesel	1.3 Gal/hr (4.9 Liters/hr)
Oil Tank	0.13 Gal/hr (.49 Liters/hr)
Grease	8 to 10 Pumps Every 20 Minutes of Operation Time.

## STRIKER PLATE FOR DB26

Weight	628 lbs (284 kg)
Diameter	22.5 in (57.15 cm)
Area	398 in <sup>2</sup> (2,567.74 cm <sup>2</sup> )
Thickness	6 in (15.24 cm)

## CUSHION MATERIAL

Type/Qty	Micarata / 2 each
Diameter-DB26	22.5 in (57.15 cm)
Thickness	1 in (2.54 cm)
Type/Qty	Aluminum / 3 each
Thickness	1/2 in (1.27 cm)
Diameter	22.5 in (57.15 cm)
Total Combined Thickness	3.5 in (8.89 cm)
Area	398 in <sup>2</sup> (2,567.74 cm <sup>2</sup> )
Elastic-Modulus	285 ksi (1,965 mpa)
Coeff. of Restitution	0.8

## DRIVE CAP

DB 26:	1,076 lbs (488 kg)
--------	--------------------

## INSERT WEIGHT

H-Beam Insert for 12" (305mm) and 14" (355 mm):	948 lbs (430 kg)
Large Pipe Insert for the Sizes 12" to 24" Diameter:	1,830 lbs (830 kg)

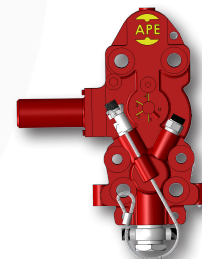
## MINIMUM LEADER SIZE/OPERATING LENGTH

Minimum Box Leader Size	8 in x 26 in (20.32 cm x 66 cm)
Operating Length with Base and Insert	354 in (900 cm)

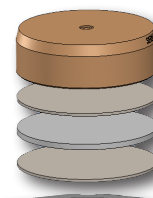


Image may not represent actual Model

Optional Variable Throttle Control



Drive Base Assembly



Striker plate

Aluminum

Micarta

Aluminum

Drive Cap Base



WWW.AMERICANPILEDRIVING.COM

Ape@americanpiledriving.com

Specifications may vary due to site conditions, specific hammer conditions or product set up.

Specifications may change without notice.

Consult the factory for details on any specific product (800) 248-8498.

Copyright © 2022 American Piledriving Equipment Inc. All Rights Reserved

