

Capable of driving up to 105" Pipe Pile

10" X 54" Taper Top (9,571lbs)

108" Diameter X 30" thick Striker Plate (77,940lbs)

Bottom Drive Cage w/ Adjustable Boots (13,424lbs)

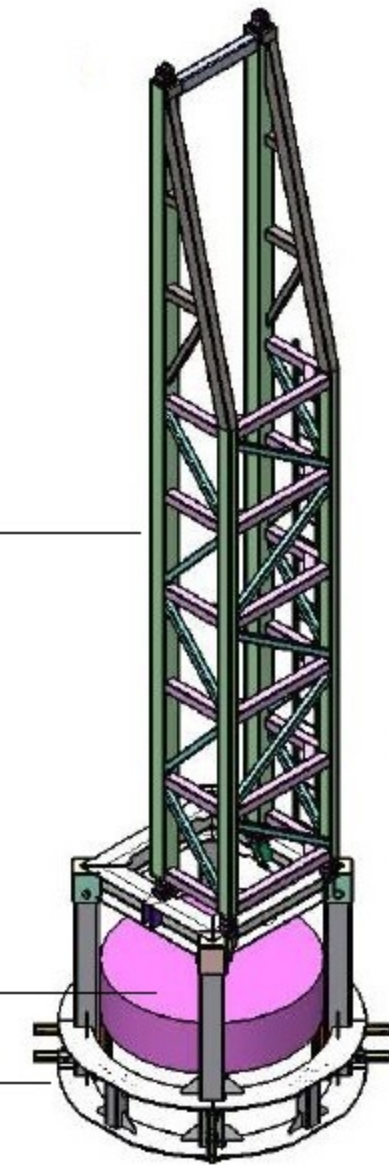

BOTTOM DRIVE COMPLETE
100,935 LBS

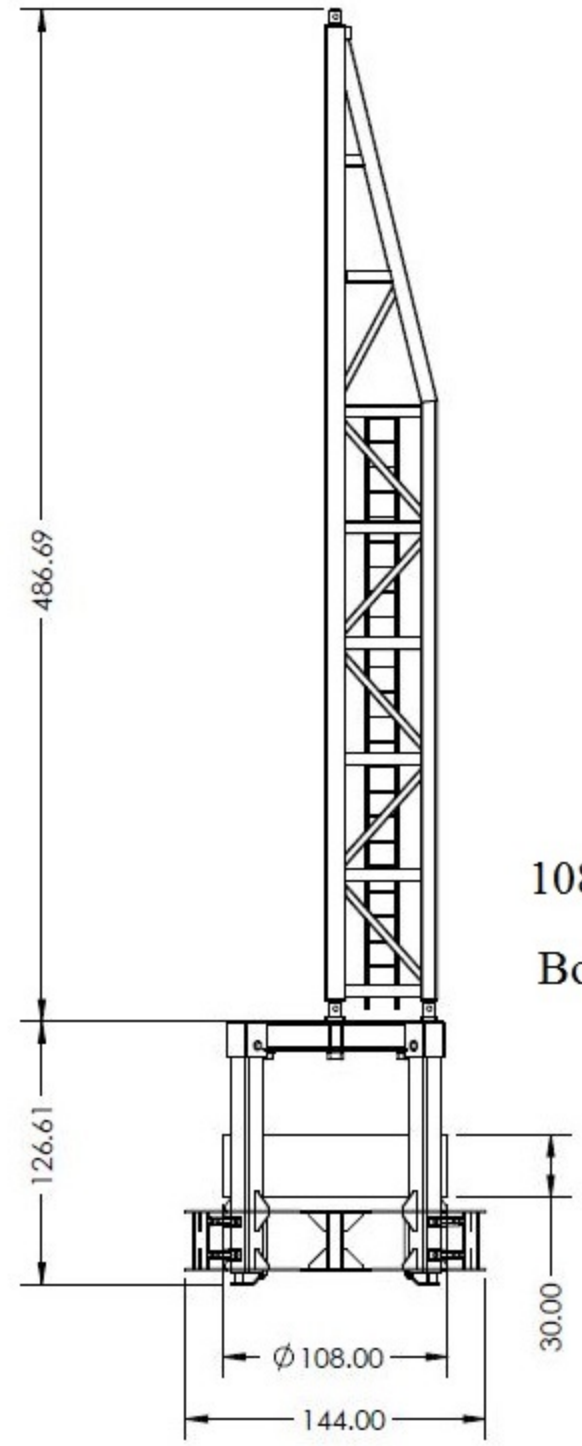

PROPRIETARY AND CONFIDENTIAL
THE INFORMATION CONTAINED IN THIS DRAWING IS THE SOLE PROPERTY OF AMERICAN PILEDIVING EQUIPMENT. ANY REPRODUCTION IN PART OR AS A WHOLE WITHOUT THE WRITTEN PERMISSION OF AMERICAN PILEDIVING EQUIPMENT IS PROHIBITED. THE APE PRODUCT LINE IS PROTECTED BY VARIOUS PATENTS. FOR A LIST OF PATENTS, PLEASE VISIT OUR WEBSITE: www.apeltd.com/vw2/apeltd.html.
FILED IN THE OFFICE OF THE CLERK OF THE DISTRICT COURT OF WASHINGTON
12/28/2011 10:58 AM

UNLESS OTHERWISE SPECIFIED:		NAME	DATE
DIMENSIONS ARE IN INCHES		DRAWN	CHEN CZ
TOLERANCES:		CHECKED	
FRACTIONAL ±		ENG APPR.	
ANGULAR: MACH ± BEND ±		MFG APPR.	
TWO PLACE DECIMAL ±		Q.A.	
THREE PLACE DECIMAL ±		COMMENTS:	
INTERPRET: GEOMETRIC			
TOLERANCING PER:			
MATERIAL:			
FINISH:			
DO NOT SCALE DRAWING			

	AMERICAN PILEDIVING EQUIPMENT 7032 S. 196TH ST KENT WA 98032	
	TITLE:	
SIZE	DWG. NO.	REV
B	1001855 FRAME ASM WITH 54 T.TOP	
SCALE: 1:12		WEIGHT: 100934.75 SHEET 1 OF 1